

FOR EA ONLY

SD-A-18
6mW x 3mD x 3.5mH

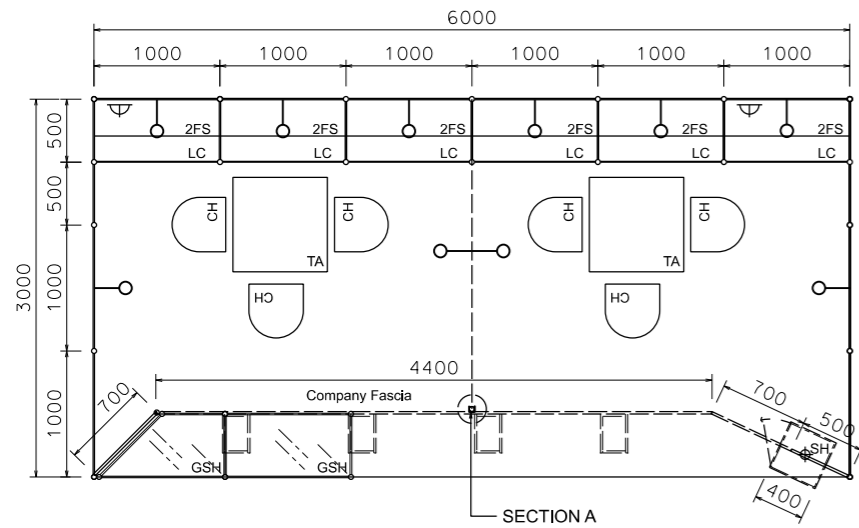

PLAN

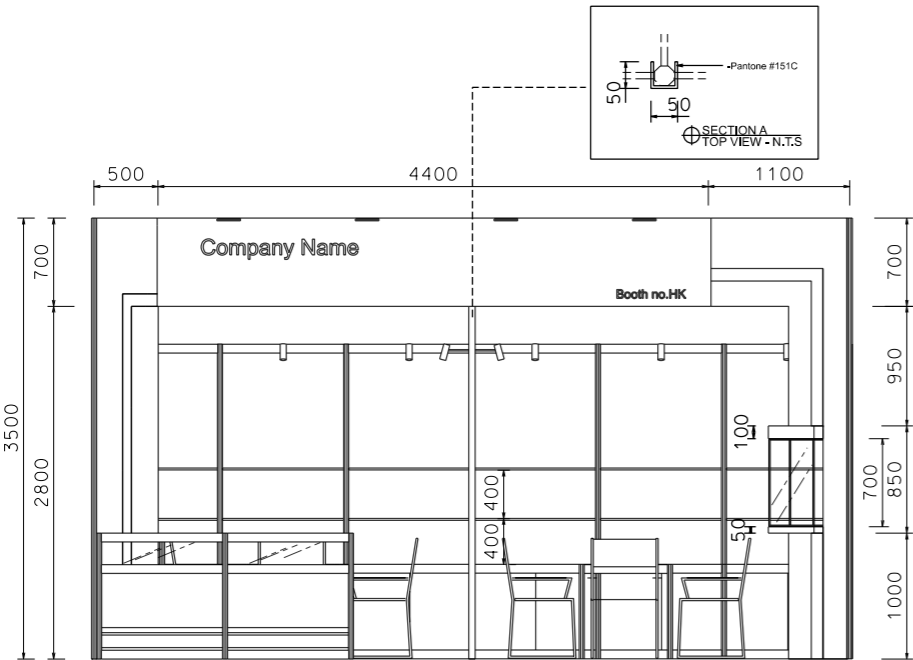

FRONT ELEVATION

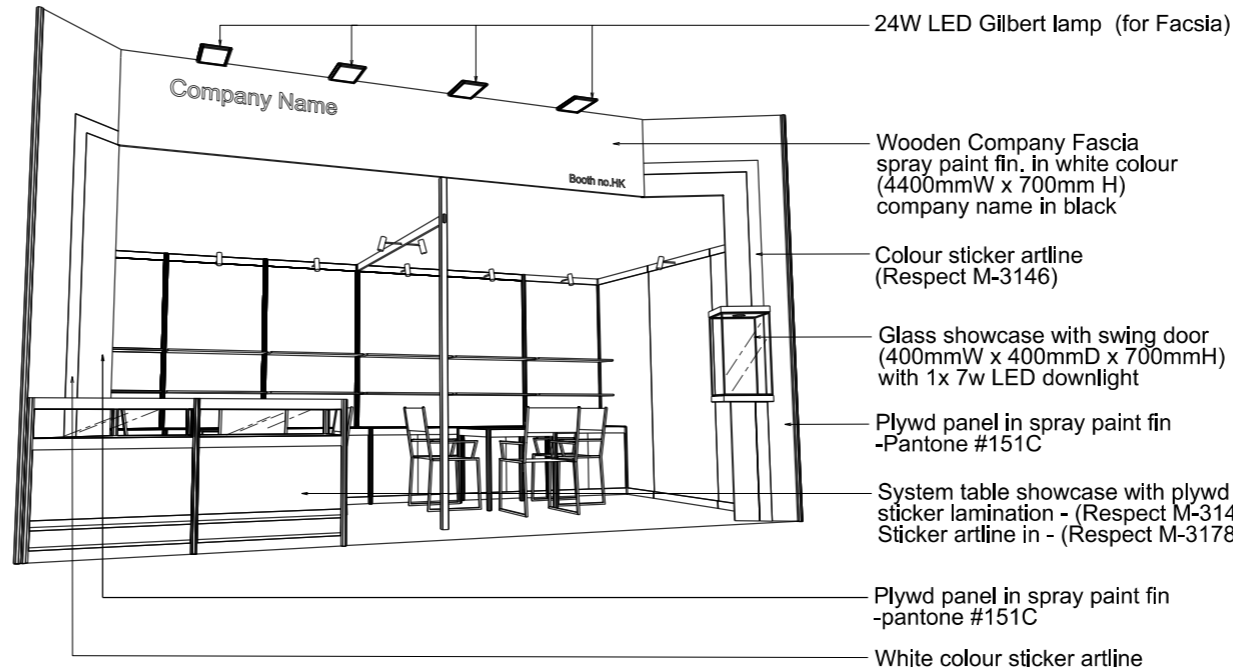

PERSPECTIVE N.T.S

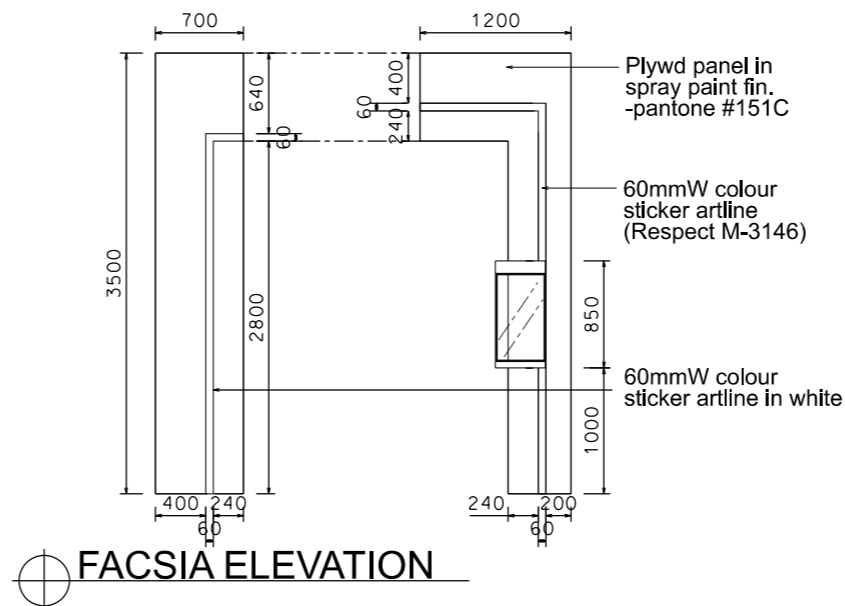

FACIA ELEVATION

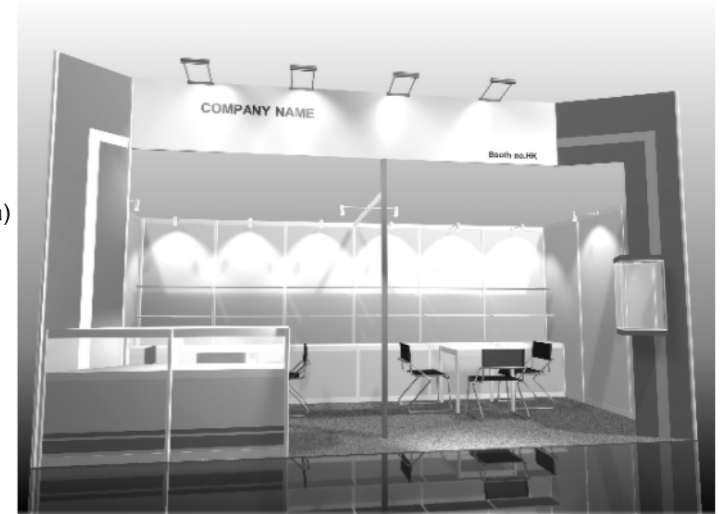

COLOUR PERSPECTIVE

BOOTH SPECIFICATION		QTY
	Front glass showcase with glass swing door, w/ 1 x 7w LED downlight (0.4m W x 0.4mD x 0.7mH)	1
	Lockable cabinet (1mL x 0.5mD x 0.75mH)	6
	Wooden shelf (flat) (1mL x 0.3mD)	12
	Glass top table showcase (2mL x 0.5mD x 1mH)	1
	Square meeting table (0.7m X 0.7m x 0.75mH)	2
	Black leather chair	6
	Longarmed spotlight w/13 watt LED lamp (yellow)	10
	24W LED Gilbert lamp (for fascia)	4
	500w Square pin power socket	2
	Rubbish Bin	2

FILE PATH - L:\Local Fair Premium Booth 2011\electronics asia\13W Lamp\PremiumBoothA1.dgn



NOTES UNLESS OTHERWISE SPECIFIED ALL DIMENSIONS ARE IN MM.

.....
.....
.....

.....
.....
.....

REVISION
1.0 28/04/2022

DATE: 15/07/2011
SCALE: 1 : 60 (A3)
DRAWN BY: DF
CHECKED BY:

TITLE
Premium Booth A
6Mx3M
(1-SIDE OPEN)

PROJECT
ELECTRONIC ASIA

DATE:

SHEET

BO2a

FOR EA ONLY

SD-A-18-L_Cnr
6mW x 3mD x 3.5mH

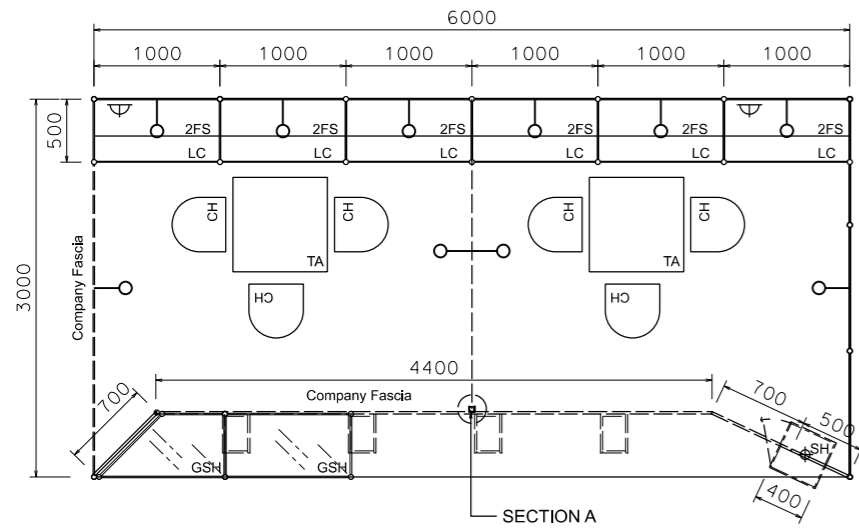

PLAN

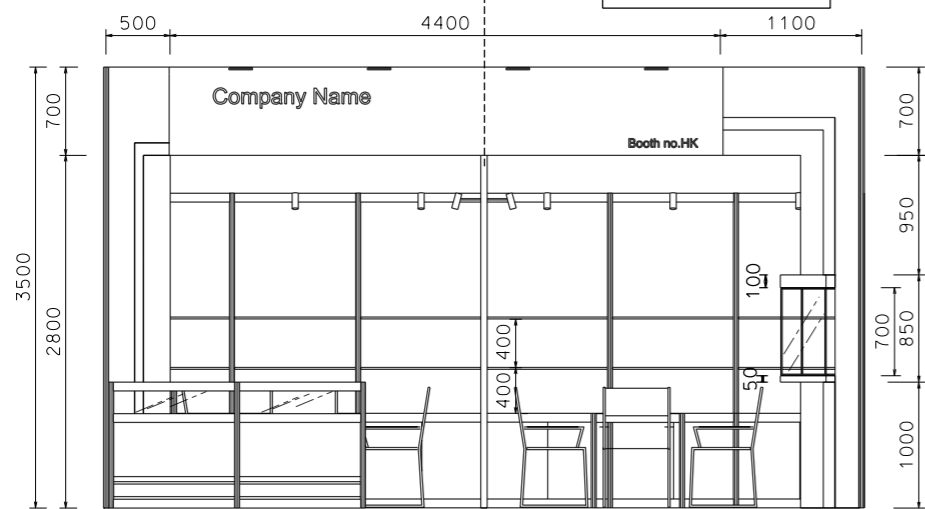
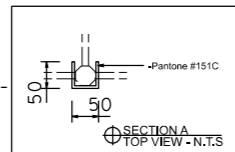

FRONT ELEVATION

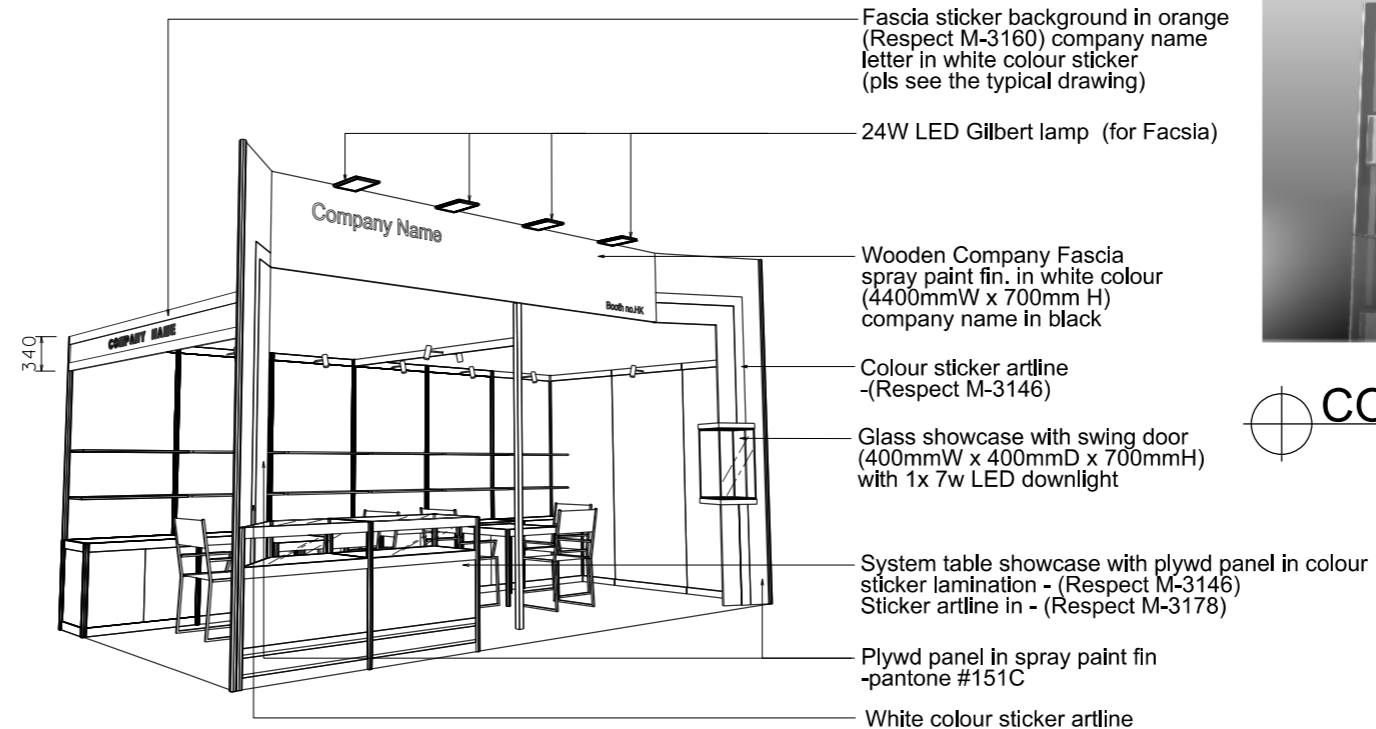

PERSPECTIVE N.T.S

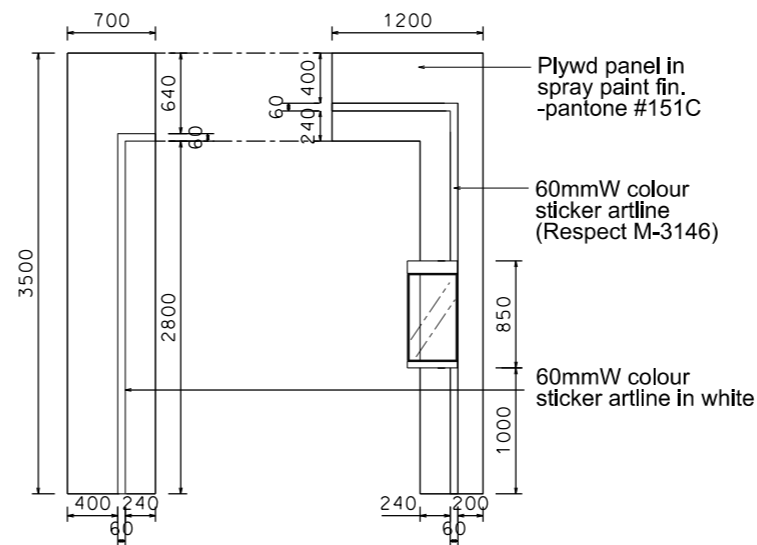

COLOUR PERSPECTIVE

BOOTH SPECIFICATION		QTY
	Front glass showcase with glass swing door, w/ 1 x 7w LED downlight (0.4m W x 0.4mD x 0.7mH)	1
	Lockable cabinet (1mL x 0.5mD x 0.75mH)	6
	Wooden shelf (flat) (1mL x 0.3mD)	12
	Glass top table showcase (2mL x 0.5mD x 1mH)	1
	Square meeting table (0.7m X 0.7m x 0.75mH)	2
	Black leather chair	6
	Longarmed spotlight w/13 watt LED lamp (yellow)	10
	24W LED Gilbert lamp (for fascia)	4
	500w Square pin power socket	2
	Rubbish Bin	2

FILE PATH - L:\Local Fair Premium Booth 2011\electronics asia\13W Lamp\PremiumBoothA1.dgn



NOTES UNLESS OTHERWISE SPECIFIED ALL DIMENSIONS ARE IN MM.

.....
.....
.....

.....
.....
.....

REVISION
1.0 28/04/2022

DATE: 15/07/2011

SCALE: 1 : 60 (A3)

DRAWN BY: DF

CHECKED BY:

TITLE

Premium Booth A
6Mx3M
(2-SIDE OPEN)

PROJECT

ELECTRONIC ASIA

DATE:

SHEET

B02b

FOR EA ONLY

SD-A-18-R Cnr
6mW x 3mD x 3.5mH

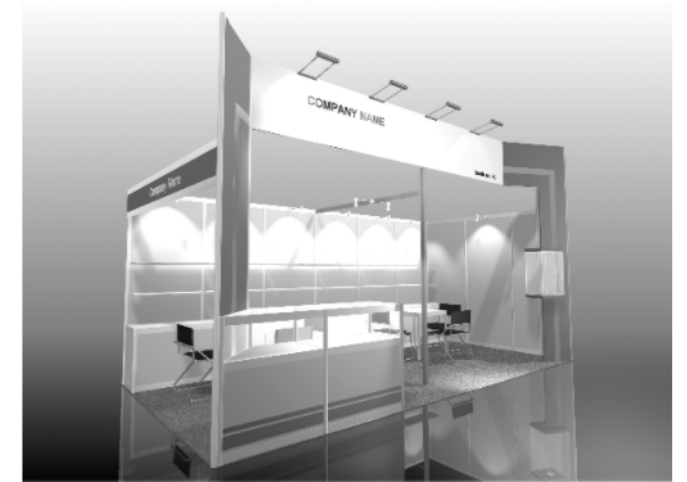

COLOUR PERSPECTIVE

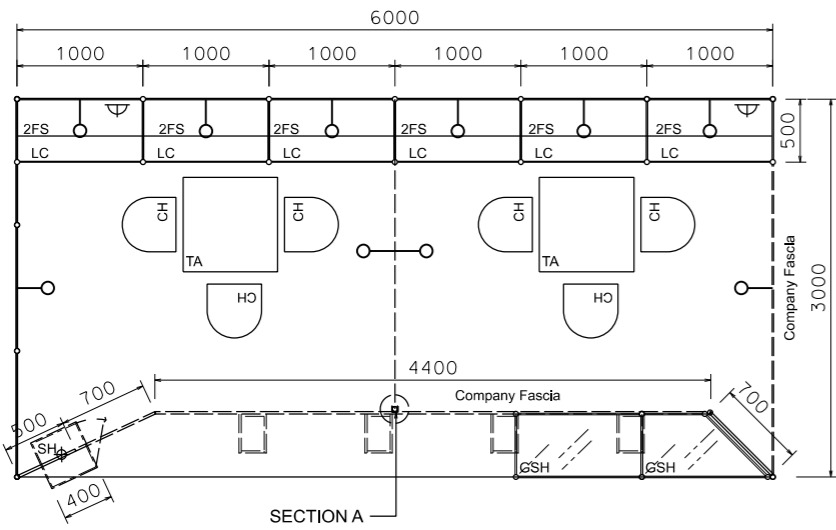

PLAN

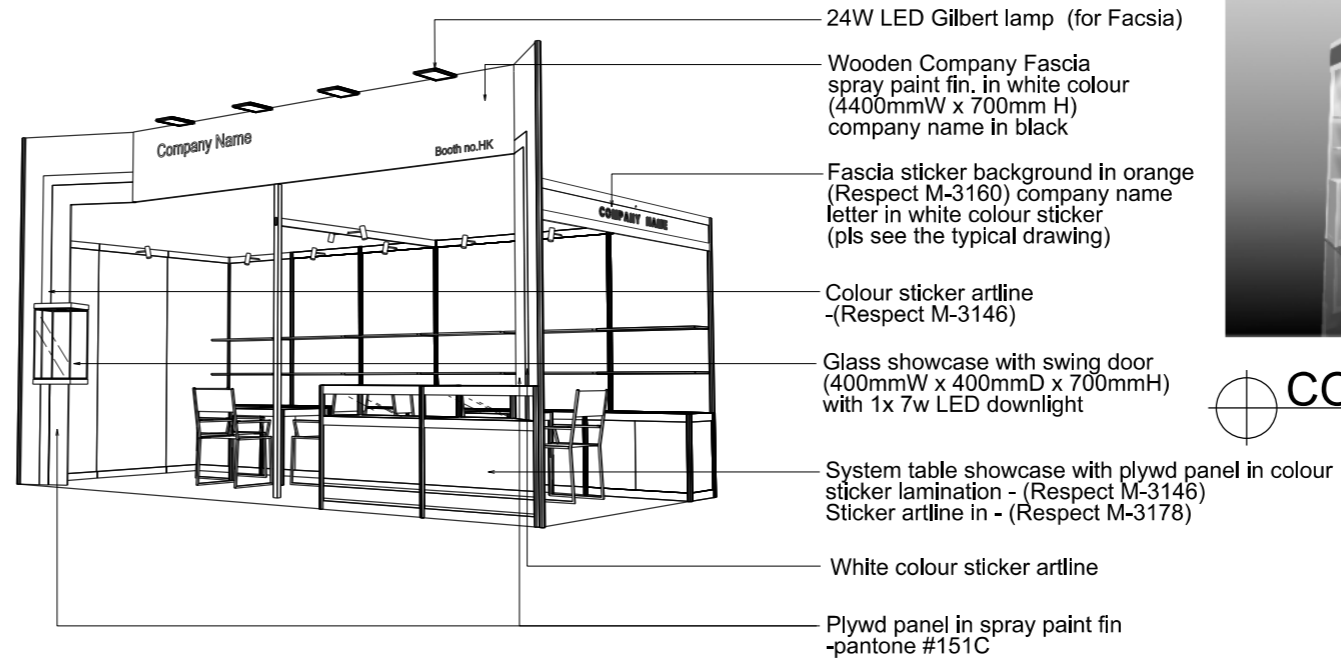

PERSPECTIVE N.T.S

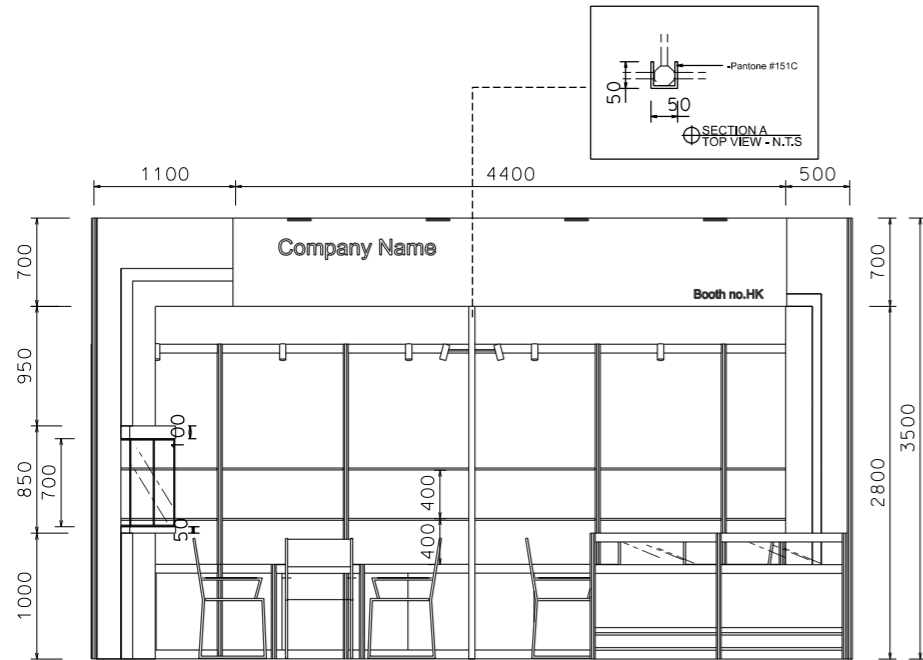

FRONT ELEVATION

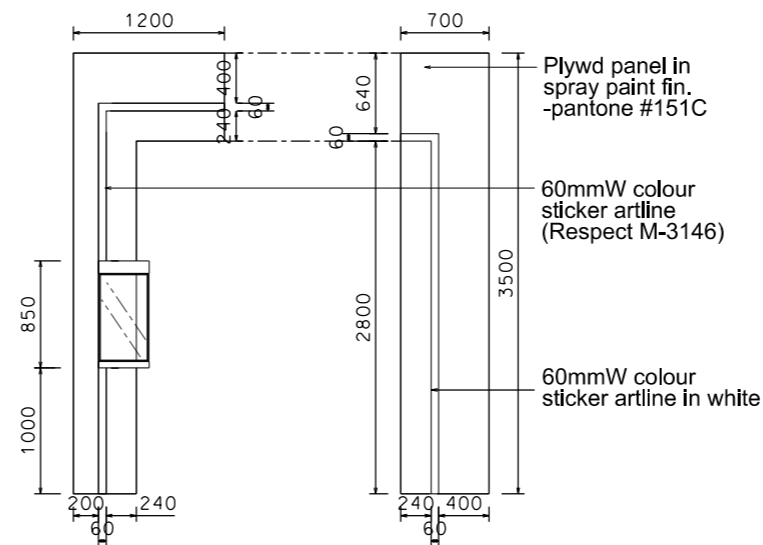

BOOTH SPECIFICATION		QTY
	Front glass showcase with glass swing door. w/ 1 x 7w LED downlight (0.4m W x 0.4mD x 0.7mH)	1
	Lockable cabinet (1mL x 0.5mD x 0.75mH)	6
	Wooden shelf (flat) (1mL x 0.3mD)	12
	Glass top table showcase (2mL x 0.5mD x 1mH)	1
	Square meeting table (0.7m X 0.7m x 0.75mH)	2
	Black leather chair	6
	Longarmed spotlight w/13 watt LED lamp (yellow)	10
	24W LED Gilbert lamp (for fascia)	4
	500w Square pin power socket	2
	Rubbish Bin	2

FILE PATH - L:\Local Fair Premium Booth 2011\electronics asia\13W Lamp\PremiumBoothA1.dgn



NOTES UNLESS OTHERWISE SPECIFIED ALL DIMENSIONS ARE IN MM.

.....
.....
.....

.....
.....
.....

REVISION
1.0 28/04/2022

DATE: 15/07/2011

SCALE: 1 : 60 (A3)

DRAWN BY: DF

CHECKED BY:

TITLE

Premium Booth A
6Mx3M
(2-SIDE OPEN)

PROJECT

ELECTRONIC ASIA

DATE:

SHEET

BO2C